

Unmanned Recommended Layout
(for both sides of operation)

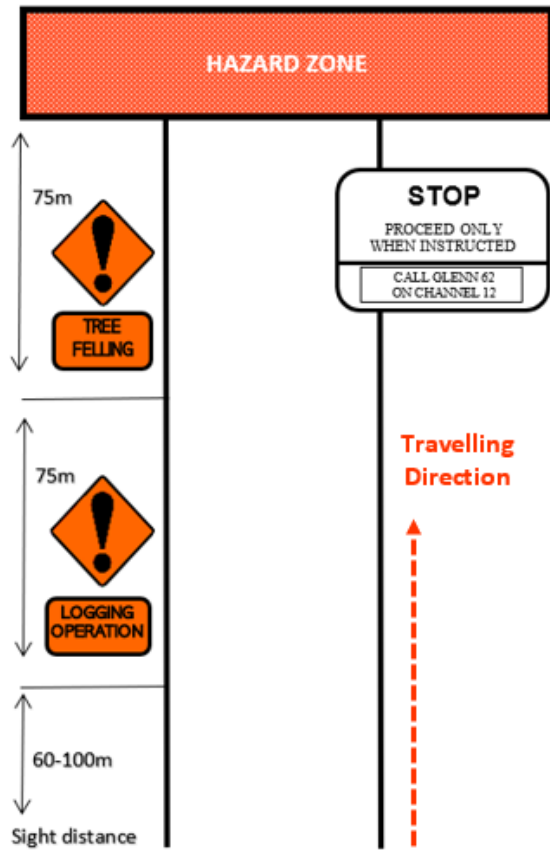

Fig 4

Closing of Forest or Private Roads

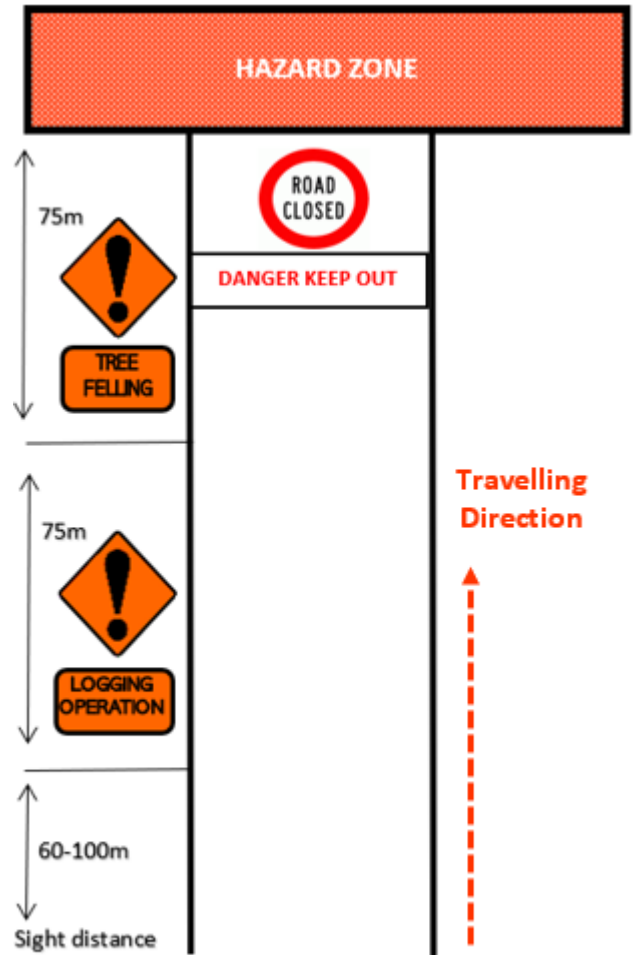

Fig 6

Flagman Controlled Recommended Layout
(for both sides of operation)

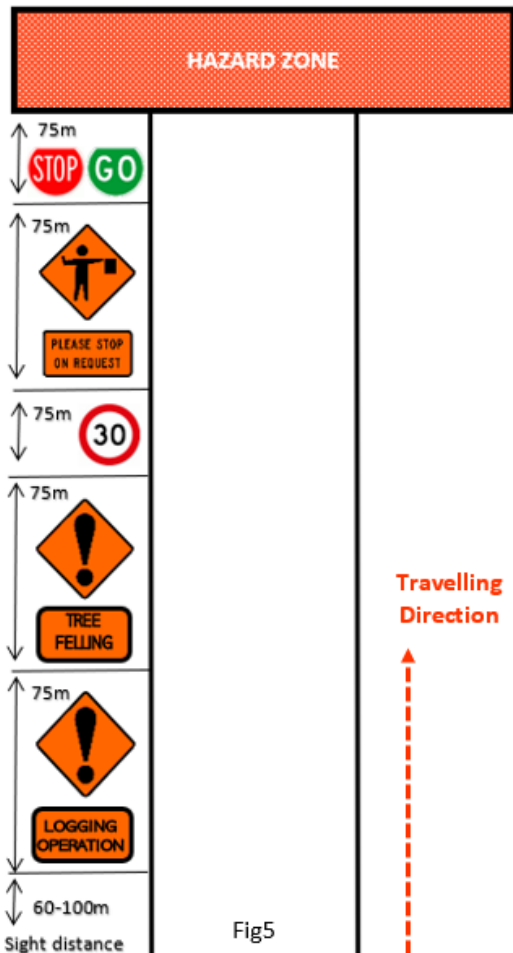

Fig5

Chain Shot

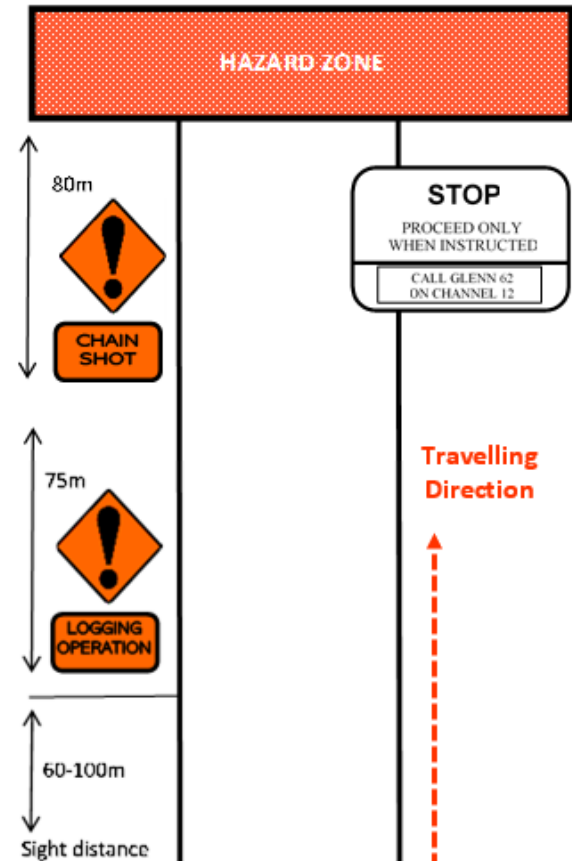

Fig 7

Logging Operations

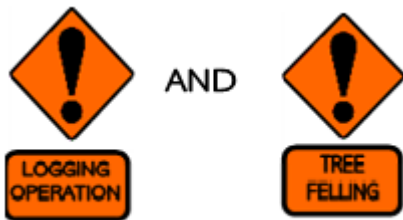

Fig 8

Roading and Roadside Operations

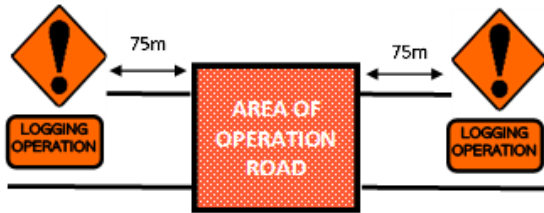

Fig 9



Fig 10

Aerial Spraying



Fig 11